

TOORAK ROAD GARDEN

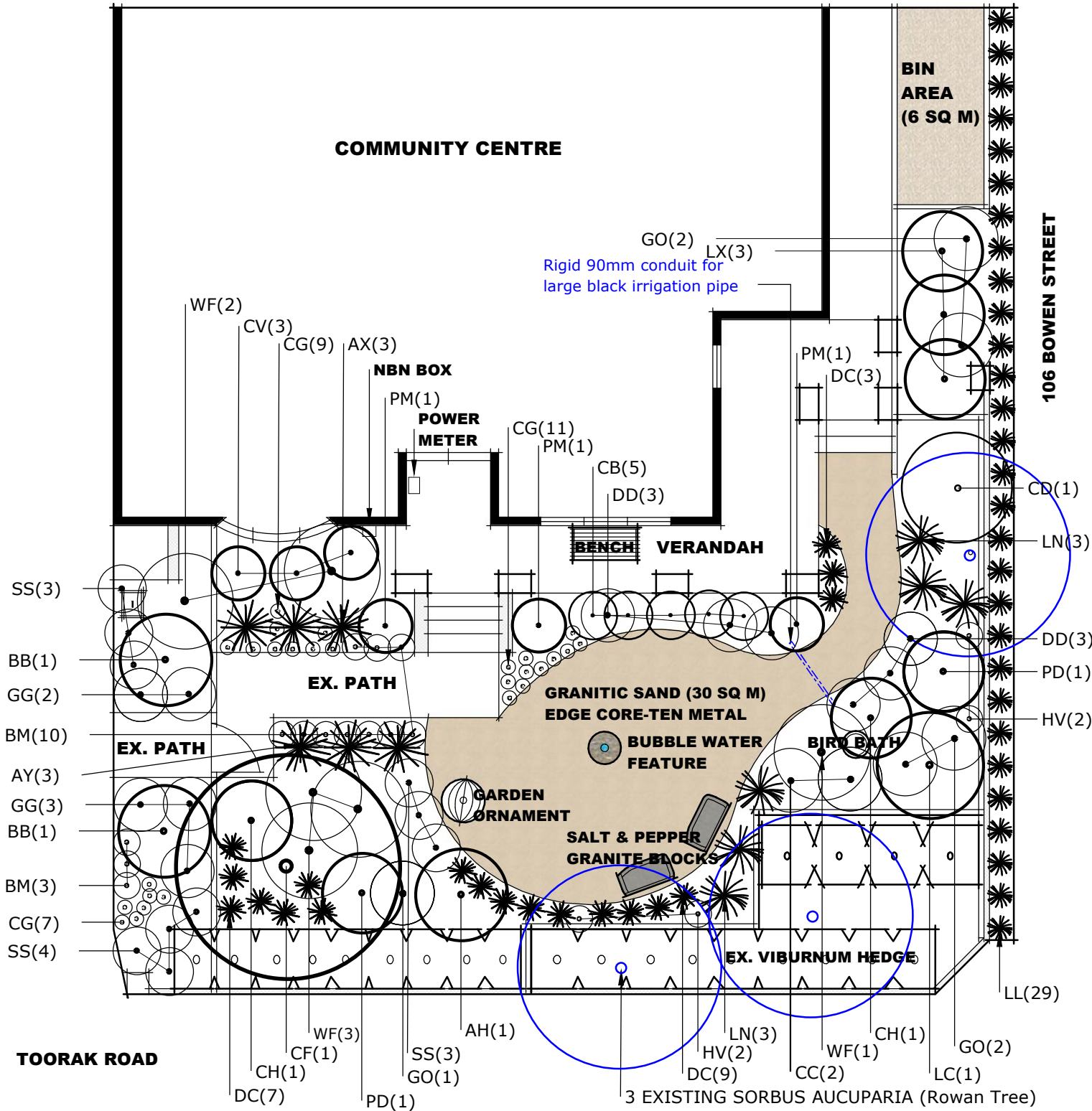

MATERIALS NOTES

Landscaper to check all measurements onsite and organise any permits required.

Site preparation: Viburnum hedge plus three Rowan trees outlined in blue, must be retained. Prepare site for landscaping; making sure major roots of site trees are protected. Ensure all areas of granitic sand and toppings have a fall away from house of minimum of 2%.

Metal edging: Install Formboss core-ten metal edging (1.6mm gauge x 75mm high) around granitic sand. Note that one-third of metal must go in ground. All edges to have rounded top edge. Length of metal approximately 25 M.

Granitic Sand: Lay granitic sand (decomposed granite) on a 50mm bed of compacted crushed rock to a minimum depth of 50mm, moisten with water and compact with a roller or vibrating plate compacter. Do not over water.

Bin area: Install Tuscan toppings on a crushed rock base and compact as above, or refresh existing toppings.

Seating: Install two salt and pepper granite blocks. *Landscaper to select rocks suitable for seating at least four adults.*

Drainage & Soil preparation: Ensure Garden beds and lawn have an appropriate fall away from house. Cultivate existing soil to a depth of 200mm. Spread aged compost material, such as Zoo Gro soil conditioner 50-100mm thick and dig to a depth of 150-200mm. Do not use mushroom compost.

Power & Water: Determine location of water source. Landscaper to provide 240 Volt power plus water for water feature, where shown. Feature to be installed later. Install 90mm rigid pvc pipe under metal edge and granitic sand, as conduit for irrigation pipe, as shown.

Irrigation: *Landscaper to design automatic wireless irrigation system, including laying of conduit as required.* Install dripper hose in a grid pattern 400mm apart under mulch for garden beds.

Garden Ornaments: Birdbath, water feature and metal ornament to be selected by community center staff.

Mulch: After planting and irrigation are complete, spread organic mulch, such as coarse pine bark, to depth of 75mm.

PLANT SCHEDULE

SYM	BOTANICAL NAME	COMMON NAME	H x W	POT SIZE	QTY
TREES					
CF	<i>Corymbia ficifolia</i> Dwarf (red or pink)	Grafted Flowering Gum	4-6m x 3-4m	20cm	1
SHRUBS					
AH	<i>Alyogyne huegelii</i> 'Balliang Beauty' (or <i>A. h.</i> 'Karana' or <i>A. h.</i> 'Misty')		1.5 x 1.5m	14cm	1
BB	<i>Banksia</i> 'Bird Song'		1.5 x 1.5m	14cm	2
CV	<i>Callistemon viminalis</i> 'Scarlet Flame'	Weeping Bottlebrush	0.6-1.5m x 0.6-1m	14cm	3
CC	<i>Chorizema cordatum</i>		1.2 x 1.2m	14cm	2
CB	<i>Correa</i> 'Canberra Bells'	Native Fuchsia	60-100cm x 60-100cm	14cm	5
CH	<i>Correa hybrid</i> 'Catie Bec'	Native Fuchsia	1 x 1.5m	14cm	2
CD	<i>Correa</i> 'Dusky Bells'	Native Fuchsia	50-100cm x 2-4m	14cm	1
GG	<i>Grevillea</i> 'Gold Cluster'		1.5 x 1.5m	14cm	5
LX	<i>Leptospermum petersonii</i> 'Little Lemon Scents'	Scented Tea Tree	1.5-2 x 1.5m	14cm	3
LC	<i>Leptospermum continentale</i>	Prickly Tea Tree	2 x 2m	14cm	1
PD	<i>Prostanthera denticulata</i> 'Mauve Mantle'	Native Mint Bush	0.8-1 x 1-2m	14cm	2
PM	<i>Prostranthera rotundifolia</i> 'Mini Pink'	Native Mint Bush	1 x 1 m	14cm	3
PERENNIALS, ANNUALS, GRASSES & BULBS					
AX	<i>Anigozanthus</i> 'Landscape Scarlet'	Tall Kangaroo Paw	1-2 x 0.5-1m	14cm	3
AY	<i>Anigozanthus</i> 'Landscape Yellow'	Tall Kangaroo Paw	1-2 x 0.5-1m	14cm	3
BM	<i>Brachyscome multifida</i>	White Cut Leaf Daisy	30-60 x 30-60cm	tube	13
CG	<i>Craspedia globosa</i> (syn. <i>Pycnosorus globosus</i>)	Billy Buttons	0.3-1m x 30cm	tube	27
DC	<i>Dianella</i> 'Clarity Blue'	Clarity Blue Dianella	60 x 50cm	tube	19
LL	<i>Lomandra</i> 'Little Lime'	Mat Rush	50 x 50cm	tube (~5 plants per 3m)	29
LN	<i>Lomandra longifolia</i> 'Nyalla'	Mat Rush	0.7-0.8 x 0.8-1m	14cm	6
SS	<i>Senecio serpens</i>	Chalk Sticks	30 x 90cm	10cm	10
CLIMBERS & GROUND COVERS					
DD	<i>Damperia diversifolia</i>		0.3 x 1m	tube	6
GO	<i>Goodenia ovata</i> 'Gold Cover'		30cm x 1-2m	tube	5
HV	<i>Hardenbergia violacea</i> 'Happy Wanderer'		2 x 2m	14cm	4
WF	<i>Westringia</i> 'Flat n Fruity'		0.3 x 1-2m	14cm	6

PLANT NOTES

Plant sourcing: Plants must conform to the botanical name, size/height and quantities in Plant Schedule. Purchase plants which are vigorous, have large healthy root systems, and are not pot bound, are free from pests and diseases and an appropriate form for that species. *Any changes to be confirmed with landscape designer.*

General planting: Dig a hole wider than the pot, ensure plant is moist and remove from pot. After planting, add slow release native fertiliser at the quantities specified by the manufacturer and water all plants thoroughly.

 <p>DESIGNED BY Diane Beddison Beddison Garden Designs 0422 190 309 diane@beddisingardendesigns.com www.beddisingardendesigns.com</p>	<p>DRG BY Diane Beddison © Copyright 2022</p>	<p>CLIENT Mary Liston Bowen Street Community Centre 106 Bowen Street Camberwell VIC 3124</p>	<p>PLAN TYPE Landscaping Plan</p>	<p>DRG NO 001</p>	<p>DATE 11/05/2022</p>	<p>VERSION V1</p>	<p>SCALE 1:100 @ A3</p> 